

LED FLOODLIGHT SERIES EXP 17 MLED

Zones 2, 22

Full catalogue available on our website: www.inpratex.com

ATEX FLOODLIGHTS

ZONES 2 (gas) & 22 (dust)



The EXP 17 MLED luminaire is designed to light the industrial areas and facilities, also outdoor spaces with an explosion hazard of gases, vapours and flammable fogs mixed with air and inflammable dust and fibers mixed with air.

Luminaire equipped with lens mounted on LED panel for light pattern shaping and reducing glare.

Available in 1,2 or 3 modules version.

DALI system and Colour temperature 3000K on request.





Declaration of Conformity

ITEM REFERENCES

Designation:	Modules:	Power:	Lumin. flux:	Weight:	Item No.:
EXP 17 MLED1/0406/7/740/N	1	45 W	7200 lm	7,5 kg	1B1401
EXP 17 MLED2/0796/7/740/N	2	85 W	14000 lm	11 Kg	1B1402
EXP 17 MLED3/1196/7/740/N	3	130 W	21000 lm	17 kg	1B1403

TECHNICAL SPECIFICATIONS

Marking:	 II 3G Ex ec IIC T4 Gb  II 3D Ex tc IIIC T100°C Dc
Certificate:	Declaration of Conformity
Operating temperature:	-30°C to +45°C
Housing:	Aluminium, powder painted
Diffuser:	Strengthened glass
Bracket:	Steel, powder painted
Rated voltage:	220-240V AC/DC
LED:	CRI: 70 / Lifetime: 130 000 h / Colour temp.: 4000K / Optics: narrow, symmetrical "N"
Terminals:	2x 3~4 mm ²
Ingress protection:	IP66
Cable entries:	2xM20x1,5 (plastic cable glands 6-12 mm)

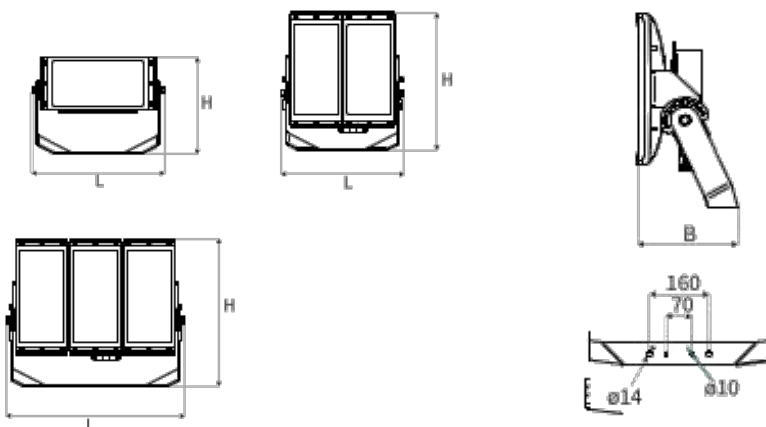

DIMENSIONS (mm)

	L	B	H
EXP 17 MLED1	388	147	340
EXP 17 MLED2	312	153	407
EXP 17 MLED3	526	204	436